

DRAWING NO.  
40-0696-40EX

ITEM NO.	QTY.	PART NO.	DESCRIPTION
1	2	42-0231-100	ENTRY BEZEL
2	2	42-0038-100	REJECT BUTTON ASY. YELLOW \$1.00 4X.25 1 PLAY W/L SHAFT
3	2	43-1002-00	WASHER, FLAT #6
4	2	42-8156-00	MECH HOLDER W/2 METAL CLIPS & 14V LMP SW .25 HAPP MECH
5	2	42-0232-100	RETURN BEZEL
6	2	42-0119-00	RETURN DOOR FLAP
7	1	42-0063-00	KEY HOOK
8	1	42-0065-00	SCREW 8 X 1/4
9	1	42-0641-00	LOCK ASSY 7/8 W/1 1/8" STRAIGHT CAM
10	1	95-0278-00	DANGER LABEL
11	8	48-1000-00	SCREW FOR BEZEL
12	4	43-1003-00	SCREW, PLASTIC #4 X .42
13	1	890-1060-00	LABEL UPSTACKER INSTRUCTIONS
14	1	42-0254-02	LOCKWASHER, F/LOCK 3/4" INT.
15	1	42-3696-100	COIN DOOR PINBALL 2 ENTRY WITH VALIDATOR PLATES INSTALLED
16	1	891-1701-016	FRAME STD DRII S2000 NOTCH BLK
17	4	890-1002-00	SCREW F/ HINGE M3X6MM .5 PITCH PH PAN HD ZINC
18	2	42-1035-00	INCLINED PLASTIC SEPERATOR IL 7 DEGREES
19	1	42-1039-00	BRACKET F/NRI WAKE-UP SENSOR
20	1	42-0314-00	SCREW 6-32 X 3/8 PH PN HD
21	4	43-0066-00	WASHER, #4 FLAT
22	4	43-0203-00	NUT, HEX M3

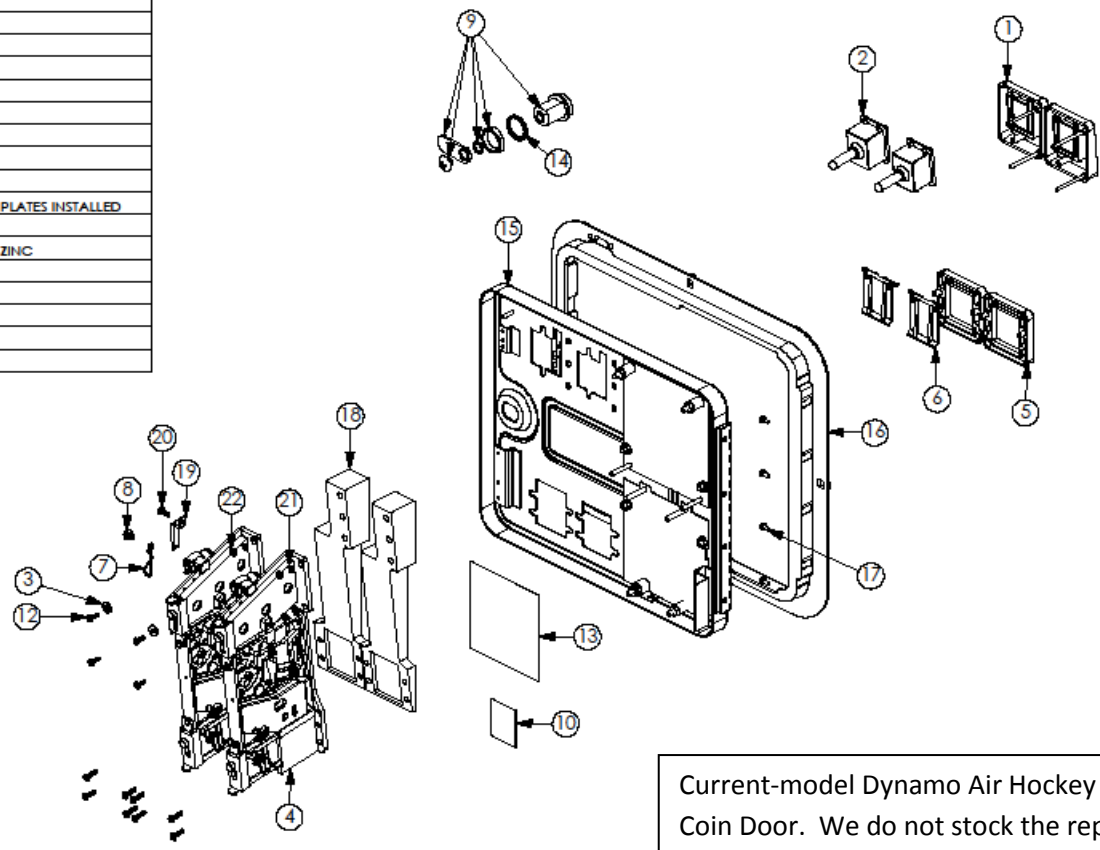

NOTE:  
ITEM NOT SHOWN:  
INS-0024 (INSTRUCTIONS ULT \$.25 US COIN MECHANISM)

Current-model Dynamo Air Hockey tables use this Happ Coin Door. We do not stock the replacement parts from this door, but they should be readily available from Happ Controls. Contact them at (888)-289-4277 or [www.happcontrols.com](http://www.happcontrols.com).

Useful part numbers are shown on this drawing.

